



ライケット(エレベータバケット)

大日ハンソー

●ライケット (粉粒体エレベータバケット)

●ナイロン製

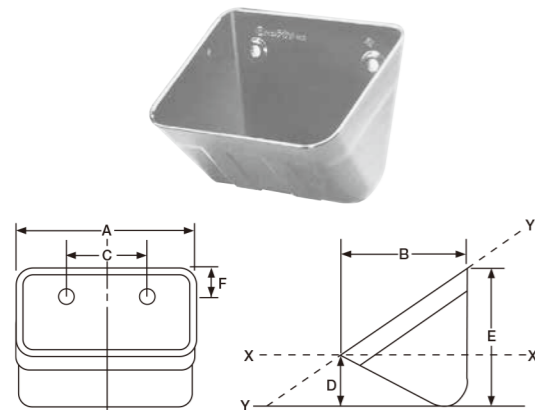

ライケット

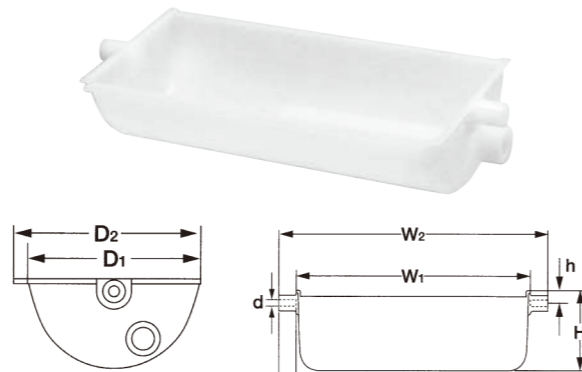

ピボテッドバケット

●ライケット

| スタイル | 呼称 | 価格 | | A | B | C | D | E | F | 孔径 | 孔数 | X-X容積 cm ³ | Y-Y容積 cm ³ | 取付 ボタン |
|---------|---------|-------|-------|-------|-----|----------|-----|-----|------|------|----|--------------------------|--------------------------|-----------|
| | | 黒(B) | 白(W) | | | | | | | | | | | |
| スタンダード | 3II | 160 | 170 | 77 | 54 | 41 | 31 | 72 | 18 | 7.0 | 2 | 80 | 130 | M6 |
| | 3½I | 200 | — | 88 | 72 | 47 | 42 | 83 | 19 | 7.0 | 2 | 155 | 245 | M6 |
| | 4III | 220 | 240 | 98 | 73 | 53 | 45 | 84 | 21 | 7.0 | 2 | 176 | 270 | M6 |
| | 4½II | 280 | — | 107 | 75 | 63 | 47 | 88 | 22 | 7.0 | 2 | 212 | 330 | M6 |
| | 5II | 360 | 390 | 120 | 84 | 78 | 45 | 98 | 26 | 7.5 | 2 | 250 | 460 | M6 |
| | 6II | 650 | 750 | 146 | 102 | 92 | 52 | 116 | 28 | 7.5 | 2 | 450 | 760 | M6 |
| | 8II | 1,280 | 1,460 | 196 | 132 | 138 | 65 | 150 | 33 | 9.0 | 2 | 940 | 1,800 | M8 |
| | 10II | 1,900 | 2,300 | 246 | 155 | 50-70-50 | 84 | 180 | 44 | 9.0 | 4 | 1,750 | 3,150 | M8 |
| ニフティ | 12III | 2,310 | 2,720 | 300 | 155 | 70-70-70 | 78 | 182 | 46 | 9.0 | 4 | 1,995 | 4,000 | M8 |
| | 14II | — | 3,870 | 349 | 182 | 90-90-90 | 80 | 189 | 38 | 9.0 | 4 | 3,300 | 5,500 | M8 |
| | N-4I | 320 | — | 94 | 83 | 48 | 47 | 82 | 25 | 6.5 | 2 | 200 | 305 | M6 |
| | N-5I | 510 | — | 111 | 100 | 62 | 52 | 100 | 25 | 6.5 | 2 | 315 | 535 | M6 |
| | N-6II | 720 | 820 | 146 | 113 | 93 | 59 | 116 | 28 | 8.0 | 2 | 560 | 900 | M6 |
| | N-7II | 1,260 | 1,410 | 171 | 133 | 113 | 71 | 134 | 34 | 9.0 | 2 | 900 | 1,500 | M8 |
| | N-8II | 1,670 | — | 203 | 152 | 130 | 88 | 152 | 38 | 9.0 | 2 | 1,570 | 2,250 | M8 |
| | N-10II | 2,550 | 2,930 | 252 | 183 | 50-70-50 | 106 | 180 | 43 | 9.0 | 4 | 2,500 | 3,800 | M8 |
| キープ | N-12II | 2,940 | 3,360 | 302 | 176 | 68-72-68 | 97 | 181 | 40 | 9.5 | 4 | 2,800 | 4,500 | M8 |
| | K-7II | 900 | 1,410 | 171 | 113 | 113 | 57 | 135 | 33 | 9.0 | 2 | 610 | 1,180 | M8 |
| 浅 | K-9I | 1,690 | — | 231 | 137 | 82-82 | 71 | 128 | 33 | 9.0 | 3 | 1,250 | 1,950 | M8 |
| | A-4III | 170 | — | 107.5 | 63 | 57.5 | 27 | 59 | 15.5 | 7.0 | 2 | 84 | 170 | M6 |
| | MG-6I | 640 | — | 145 | 108 | 92 | 34 | 121 | 27 | 7.5 | 2 | 280 | 800 | M6 |
| コロンブス | MG-8I | 1,270 | — | 195 | 131 | 138 | 49 | 152 | 33 | 9.0 | 2 | 650 | 1,700 | M8 |
| | C-9I | 1,950 | — | 241 | 134 | 79-79 | 95 | 167 | 37 | 9.0 | 3 | 1,800 | 2,750 | M8 |
| ショートカット | C-11I | 2,280 | — | 291 | 134 | 67-67-67 | 95 | 165 | 37 | 9.0 | 4 | 2,190 | 3,340 | M8 |
| | SC-112I | 310 | — | 112 | 75 | 63 | 46 | 75 | 19.5 | 7.0 | 2 | 230 | 320 | M6 |
| | SC-125I | 360 | — | 125 | 84 | 78 | 45 | 70 | 13.5 | 7.0 | 2 | 270 | 370 | M6 |
| 誘導 | SC-150 | 640 | — | 151 | 101 | 92 | 55 | 85 | 19.5 | 7.0 | 2 | 430 | 620 | M6 |
| | Y-4I | 400 | — | 92 | 54 | 55 | 30 | 60 | 13 | 7.0 | 2 | 88 | 145 | M6 |
| | Y-6II | 1,170 | — | 165 | 90 | 56 | 65 | 105 | 35 | 10.0 | 2 | 520 | 665 | M8 |
| | Y-8I | — | 2,010 | 184 | 126 | 113 | 119 | 167 | 96 | 10.0 | 2 | 1,270 | 1,690 | M8 |

●W-ライケット (重荷重・耐熱用)

■耐熱度130℃ (18.56kg/cm³)

| 呼称 | 価格 | | A | B | C | D | E | F | 孔径 | 孔数 | 容積 X-Xℓ | 容積 Y-Yℓ |
|--------|-------|------|-----|-----|-----------|----|-----|-------|----|----|------------|------------|
| | 黒(B) | 白(W) | | | | | | | | | | |
| W-6I | 1,540 | — | 170 | 120 | 86 | 56 | 125 | 39 | 9 | 2 | 0.62 | 1.15 |
| W-8I | 2,980 | — | 201 | 157 | 65.5-65.5 | 71 | 163 | 45 | 9 | 3 | 1.25 | 2.25 |
| W-10I | 3,620 | — | 263 | 176 | 51-54-51 | 82 | 183 | 64 | 11 | 4 | 2.00 | 3.70 |
| W-13I | 4,870 | — | 314 | 177 | 65-65-65 | 82 | 185 | 65 | 11 | 4 | 2.40 | 4.50 |
| W-13½I | 5,310 | — | 345 | 204 | 70-70-70 | 87 | 185 | 57 | 11 | 4 | 3.45 | 6.28 |
| W-16I | 6,180 | — | 405 | 208 | 146-146 | 91 | 175 | 42 72 | 11 | 5 | 4.45 | 7.00 |
| W-18I | 8,530 | — | 457 | 213 | 121-121 | 89 | 215 | 50 30 | 11 | 7 | 4.6 | 9.19 |

●ピボテッドバケット

| 呼称 | 価格 | W1 | W2 | D1 | D2 | H | h | l | d | 容積(ℓ) |
|----------|-------|-----|-----|-----|-----|-----|----|------|-----|-------|
| PS-200G | 3,310 | 205 | 240 | 157 | — | 101 | 20 | 18 | 9.5 | 1.5 |
| POL-300G | 3,950 | 306 | 352 | 148 | 160 | 75 | 10 | 20 | 9.5 | 2.3 |
| PL-550G | 8,780 | 546 | 600 | — | 237 | 131 | 20 | 26.5 | 10 | 9 |



プロサイド(スクリュウコンベヤー)

大日ハンソー

●プロサイド (粉粒体スクリュウコンベヤー)

●ナイロン製

■プロサイド寸法図

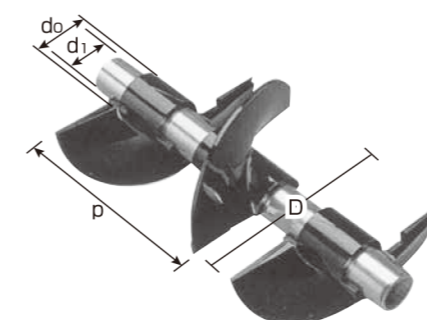

〈3個組み合わせ〉

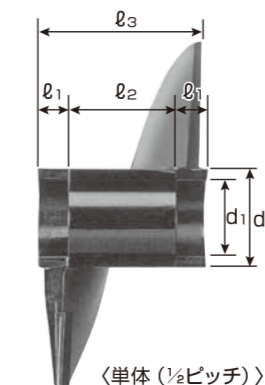

〈単体(½ピッチ)〉

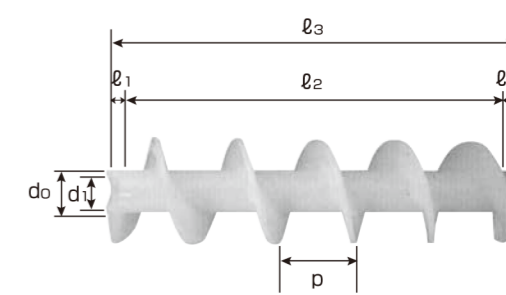

〈LGスタイル(5ピッチ)〉

※単体の形状 LGは5ピッチ、N-½RIIは¾ピッチ、その他は½ピッチです。

| 呼称 | 価格 | | 巻方向 | 外径 D 公差±1.0 | 軸外径 d-o | 軸内径 d-1 | 適応パイプ の外径 | 羽根先 の厚み | 羽根元 の厚み | P(ピッチ) 公差±1.0 | 1mあたり 組合せ数 | ℓ1 | ℓ2 | ℓ3 | |
|----------|--------|--------|-------|-------------------|------------|------------|--------------|------------|------------|------------------|---------------|------|-------|-------|-------|
| | 黒(B) | 白(W) | | | | | | | | | | | | | |
| 40R30-10 | 4,060 | | 右 | 40 | 16.0 | 10.0 | 10.0 | 2.5 | 5.0 | 30 | 6 | 6.5 | 143.5 | 156.5 | |
| 2½ | 200RI | 200 | 230 | 右 | 63 | 27.0 | 20.2 | 20.0 | 2.4 | 5.0 | 60 | 33 | 6.9 | 23.0 | 36.8 |
| | 254LI | — | 260 | 左 | 65 | 33.0 | 25.6 | 25.4 | 2.2 | 3.5 | 77 | 26 | 5.0 | 33.3 | 43.3 |
| | 254RII | 240 | — | 右 | 65 | 33.0 | 25.6 | 25.4 | 2.2 | 3.5 | 77 | 26 | 5.0 | 33.5 | 43.5 |
| 3½ | 200RI | 240 | 260 | 右 | 80 | 28.3 | 20.2 | 20.0 | 2.5 | 7.0 | 70 | 29 | 8.0 | 27.0 | 43.0 |
| | 254LI | — | 280 | 左 | 80 | 33.0 | 25.6 | 25.4 | 2.5 | 3.5 | 74 | 27 | 7.9 | 29.2 | 45.0 |
| | 254RII | 260 | — | 右 | 80 | 33.0 | 25.6 | 25.4 | 2.5 | 3.5 | 74 | 27 | 7.9 | 29.2 | 45.0 |
| 4RI | 410 | 460 | 右 | 100 | 40.0 | 32.0 | 31.8 | 2.9 | 5.0 | 80 | 25 | 9.0 | 31.0 | 49.0 | |
| 4½ | LII | 420 | 470 | 左 | 113.9 | 40.0 | 32.0 | 31.8 | 3.0 | 5.0 | 73 | 27 | 9.0 | 27.6 | 45.6 |
| | RII | 420 | 470 | 右 | 113.5 | 40.2 | 32.0 | 31.8 | 3.0 | 5.0 | 73 | 27 | 9.0 | 27.8 | 45.8 |
| 5 | LI | 630 | 720 | 左 | 124 | 40.9 | 32.0 | 31.8 | 3.0 | 8.5 | 104 | 20 | 11.3 | 39.7 | 62.3 |
| | RI | 630 | 720 | 右 | 124 | 40.0 | 32.0 | 31.8 | 3.0 | 8.5 | 104 | 20 | 8.8 | 43.5 | 61.1 |
| 6 | LII | 880 | 970 | 左 | 150 | 42.0 | 32.0 | 31.8 | 3.5 | 10.0 | 116 | 17 | 13.4 | 45.0 | 71.8 |
| | RII | 790 | 900 | 右 | 149 | 41.7 | 32.0 | 31.8 | 3.5 | 10.0 | 116 | 17 | 13.7 | 44.2 | 71.6 |
| 8 | LII | 2,010 | 2,240 | 左 | 200 | 61.3 | 49.0 | 48.6 | 3.8 | 13.0 | 159 | 13 | 16.8 | 62.0 | 95.6 |
| | RII | 2,010 | 2,240 | 右 | 200 | 60.4 | 49.0 | 48.6 | 3.5 | 13.0 | 159 | 13 | 16.4 | 63.0 | 95.8 |
| 10 | LI | — | 4,260 | 左 | 247 | 75.5 | 60.9 | 60.5 | 4.0 | 16.0 | 205 | 10 | 21.1 | 81.6 | 123.8 |
| | RII | 3,860 | 4,260 | 右 | 247 | 73.2 | 60.9 | 60.5 | 4.0 | 16.0 | 205 | 10 | 21.0 | 81.2 | 123.2 |
| 12RI | 6,910 | — | 右 | 300 | 94.4 | 76.7 | 76.3 | 4.0 | 18.5 | 200 | 10 | 26.7 | 72.5 | 125.9 | |
| 14RGI | 10,980 | | 右 | 347 | 106.5 | 89.5 | 89.1 | 4.0 | 17.5 | 238 | 9 | 27.0 | 92.0 | 146.0 | |
| 16RI | — | 11,190 | 右 | 400 | 158.0 | 141.0 | 139.8 | 4.5 | 11.0 | 320 | 6 | 15.0 | 144.0 | 174.0 | |
| 19½LI | 22,720 | | 左 | 490 | 185.0 | 165.0 | 165.2 | 6.0 | 9.0 | 324 | 6 | 20.5 | 141.5 | 182.5 | |
| 136LI | 850 | | 左 | 136 | 41.6 | 32.0 | 31.8 | 3.5 | 8.0 | 120 | 17 | 10.1 | 49.6 | 69.8 | |
| N-4½RI | 840 | 1,010 | 右 | 113 | 43.5 | 34.2 | 34.0 | 3.8 | 8.5 | 75 | 18 | 14.8 | 41.8 | 71.4 | |
| N6 | L1 | 1,360 | — | 左 | 149 | 61.0 | 49.0 | 48.6 | 4.5 | 12.0 | 133 | 15 | 19.6 | 47.0 | 86.2 |
| | R1 | 1,230 | — | 右 | 149 | 61.0 | 49.0 | 48.6 | 4.5 | 12.0 | 133 | 15 | 19.6 | 47.0 | 86.2 |
| N-8RII | 2,190 | 2,450 | 右 | 198 | 61.0 | 49.0 | 48.6 | 4.3 | 14.0 | 175 | 12 | 17.0 | 70.0 | 104.0 | |

●両端止メ金具 (スチールFCMB製カラー)

(単位: mm)

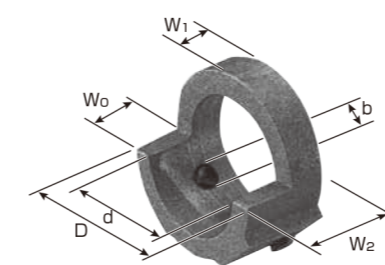

| 呼称 | 価格 | D | d | W0 | W1 | W2 | b |
|-----------------|-------|-------|------|------|------|------|-----|
| 2½-200, 3½-200用 | 420 | 29.3 | 20.2 | 7.0 | 7.0 | 14.0 | M 6 |
| 2½-254用 | 450 | 35.7 | 25.6 | 5.0 | 7.3 | 12.3 | M 8 |
| 3½-254用 | 480 | 35.7 | 25.6 | 7.9 | 7.3 | 15.2 | M 8 |
| 4.4½, 5R, 136用 | 560 | 43.8 | 32.2 | 9.0 | 10.0 | 19.0 | M 8 |
| 5L用 | 560 | 43.8 | 32.2 | 11.3 | 10.0 | 21.3 | M 8 |
| 6用 | 600 | 46.0 | 32.2 | 13.4 | 10.6 | 24.0 | M 8 |
| 8, N-8用 | 1,300 | 63.8 | 49.0 | 17.2 | 18.0 | 35.2 | M 8 |
| 10用 | 1,760 | 80.0 | 61.0 | 21.1 | 21.0 | 42.1 | M10 |
| 12用 | 2,240 | 98.5 | 76.7 | 27.0 | 23.0 | 50.0 | M10 |
| 14用 | 2,400 | 110.0 | 89.6 | 27.0 | 23.0 | 50.0 | M10 |
| N-4½用 | 660 | | | | | | |